



# BOURGADE

## UNITÉS:

214-314-414-512

## ÉTAGES:

2-3-4-5

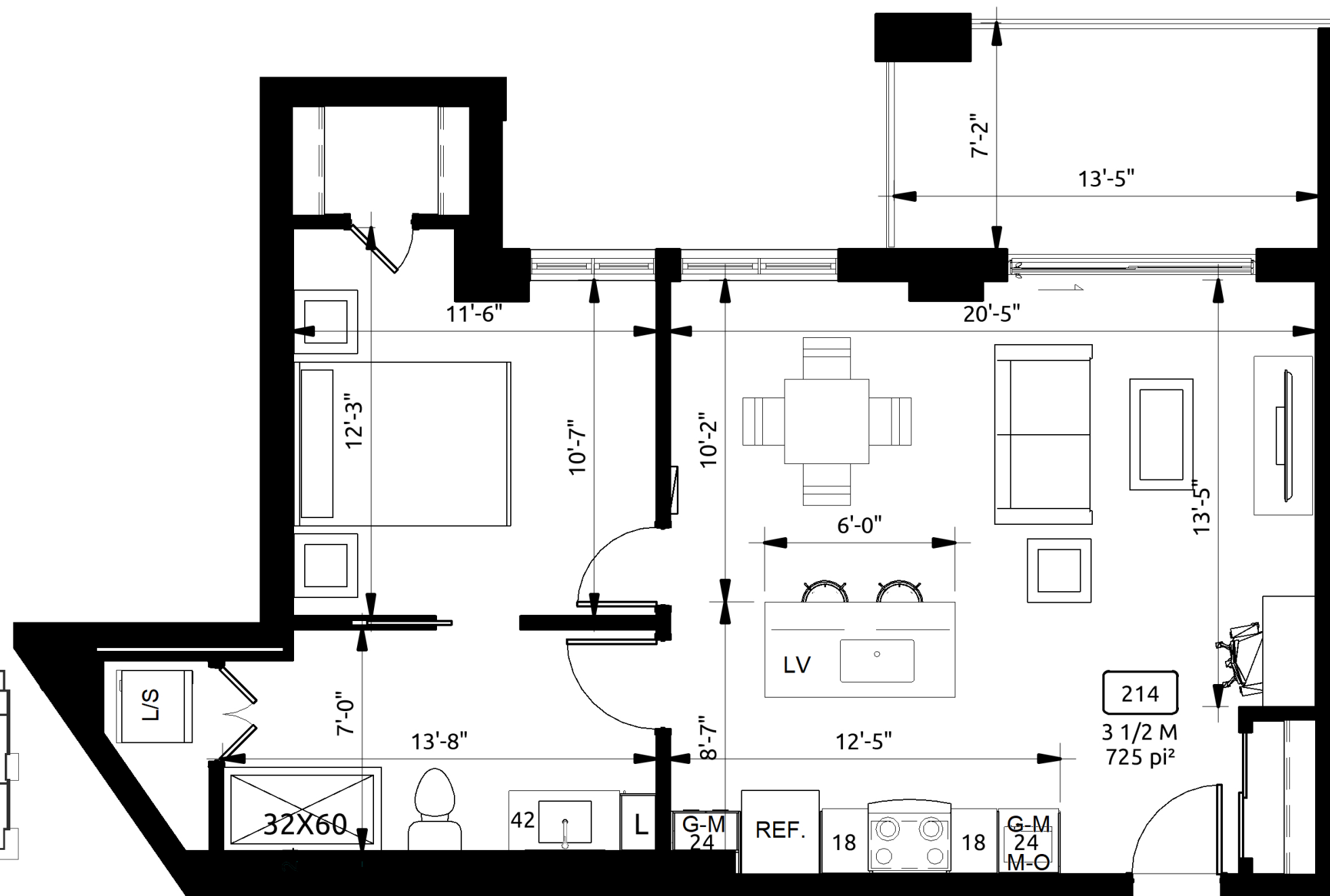
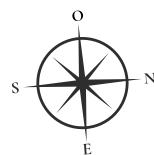

TYPE: M

3<sup>1/2</sup>

SUPERFICIE:  $\frac{725 \text{ PI}^2}{746 \text{ PI}^2}$

BALCON: 98 PI<sup>2</sup>

TOTAL: 823 PI<sup>2</sup>



1



1

BOURGADES.CA | f